



# RECORD OF SURVEY

## WITHIN THE S.E. 1/4 OF SEC. 32 AND THE S.W. 1/4 OF SEC. 33 T 28 N., R. 2 E., W.M., KITSAP COUNTY, WASHINGTON

FOR: PORT GAMBLE SKLALLAM TRIBE, A FEDERALLY RECOGNIZED INDIAN TRIBE

### SURVEY NOTES

1.) THE BASIS OF BEARINGS USED FOR THIS SURVEY IS ASSUMED N 89° 08' 30" W (WASHINGTON COORDINATE SYSTEM GRID, NORTH ZONE, NORTH AMERICAN DATUM OF 1983, 1991 ADJUSTMENT) BETWEEN THE SOUTHEAST CORNER OF SECTION 32 AND "WITNESS POINT #1" AS SHOWN HEREON AND ON VOLUME 64 OF SURVEYS, PAGE 90, RECORDS OF KITSAP COUNTY, WASHINGTON AND THE UNITED STATES DEPARTMENT OF THE INTERIOR BUREAU OF LAND MANAGEMENT DEPENDENT RESURVEY AND SUBDIVISION SURVEY PERFORMED BY ROBERT B. FINK, CADASTRAL SURVEYOR UNDER SPECIAL INSTRUCTIONS DATED APRIL 30, 2007, APPROVED MAY 2, 2007, WHICH PROVIDED FOR THE SURVEYS INCLUDED UNDER GROUP NO. 596, AND ASSIGNMENT INSTRUCTIONS DATED MAY 2, 2007. COMMENCED JUNE 19, 2007, COMPLETED APRIL 9, 2008 TOGETHER WITH THE PLAT THEREOF DATED SEPTEMBER 30, 2008.

DISTANCES SHOWN HEREON ARE GRID DISTANCES BASED UPON AN ASSUMED SCALE AND FACTOR OF 0.999948. TO OBTAIN GROUND DISTANCES MULTIPLY DISTANCES SHOWN HEREON BY 1.000052.

2.) THIS SURVEY WAS PERFORMED BY FIELD TRAVERSE USING A 5 SECOND TOTAL STATION. EDM EQUIPMENT WAS CALIBRATED ON 6-4-2009 AT THE NGS BASELINE IN PORT ANGELES.

3.) TITLE REPORT, ORDER NUMBER 200917103, AS PROVIDED BY STEWART TITLE OF KITSAP COUNTY, REVEALS THAT NO RECORDED DEED EXISTS FOR THE SUBJECT PROPERTY AND DESCRIBES SAID PROPERTY AS "AN UNLOCATABLE CEMETERY LOCATED IN THE SOUTHEAST QUARTER OF THE SOUTHEAST QUARTER OF SECTION 32 TOWNSHIP 28 N, RANGE 2 E, W.M. SITUATE IN THE COUNTY OF KITSAP, STATE OF WASHINGTON." FURTHERMORE, NO RECORD OF A DEED FOR LEGAL ACCESS TO THE SUBJECT PROPERTY WAS FOUND. THE MAPPED TRAIL AS SHOWN HEREON WAS THE ONLY VISIBLE EVIDENCE FOUND WHICH INDICATES PHYSICAL ACCESS TO THE SUBJECT PROPERTY.

4.) THE BOUNDARIES OF THE SUBJECT PROPERTY AS SHOWN HEREON ARE BASED UPON TIES TO EXISTING MONUMENTS OF RECORD SET BY DAVID WALCZYK, PLS, PER VOLUME 64 OF SURVEYS, PAGE 151, RECORDS OF KITSAP COUNTY, WA. RECORDED ON 9-15-2005. SAID SURVEY DOES NOT CONTAIN A LEGAL DESCRIPTION OR AN EXPLANATION OF HOW THE BOUNDARIES OF THIS PARCEL WERE DETERMINED.

5.) THE PURPOSE OF THIS SURVEY IS TO PROVIDE INFORMATION TO ASSIST IN PERFORMING A BOUNDARY LINE AGREEMENT BETWEEN THE SUBJECT PROPERTY AND THE SURROUNDING PROPERTY OWNERS.

6.) FOR ADJOINING SURVEYS OF RECORD SEE: VOLUME 64 OF SURVEYS, PAGE 90; VOLUME 64 OF SURVEYS, PAGE 151; VOLUME 72, PAGES 22-28 OF SURVEYS, RECORDS OF KITSAP COUNTY, WA. SEE ALSO: KITSAP COUNTY PUBLIC WORKS SECTION SUBDIVISION DATED 4-13-1995, ON FILE WITH SAID COUNTY, WASHINGTON STATE DEPARTMENT OF NATURAL RESOURCES FINAL MAP NUMBER 462, DATED SEPTEMBER 1983 AND THE UNITED STATES DEPARTMENT OF THE INTERIOR BUREAU OF LAND MANAGEMENT DEPENDENT RESURVEY AND SUBDIVISION SURVEY PERFORMED BY ROBERT B. FINK, CADASTRAL SURVEYOR UNDER SPECIAL INSTRUCTIONS DATED APRIL 30, 2007, APPROVED MAY 2, 2007, WHICH PROVIDED FOR THE SURVEYS INCLUDED UNDER GROUP NO. 596, AND ASSIGNMENT INSTRUCTIONS DATED MAY 2, 2007. COMMENCED JUNE 19, 2007, COMPLETED APRIL 9, 2008 TOGETHER WITH THE PLAT THEREOF DATED SEPTEMBER 30, 2008.

7.) THIS SURVEY DOES NOT PURPORT TO SHOW THE EXISTENCE OF ALL EASEMENTS AND OR ENCUMBRANCES RECORDED OR UNRECORDED THAT MAY AFFECT THIS PROPERTY.

8.) THIS SURVEY WAS PERFORMED ACCORDING TO WAC 332-130-090 STANDARDS FOR LAND BOUNDARY SURVEYS. THIS SURVEY WAS NOT PERFORMED OR CERTIFIED TO MEET THE "MINIMUM STANDARD DETAIL REQUIREMENTS" OR "ACCURACY STANDARDS" FOR ALTA/ACSM LAND TITLE SURVEYS. THEREFORE, THE USE OF THIS MAP FOR THE ISSUANCE OF AN ALTA/ACSM OWNER'S EXTENDED COVERAGE POLICY IS STRICTLY PROHIBITED.

PRELIMINARY

2009

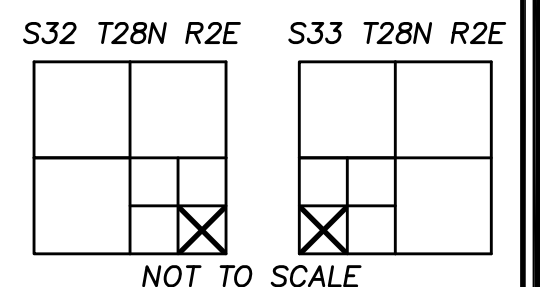

**SHEET 2 OF 2**

**AUDITOR'S CERTIFICATE**

FILED FOR RECORD THIS \_\_\_\_\_ DAY OF \_\_\_\_\_, 2009  
AT \_\_\_\_\_ M. IN BOOK \_\_\_\_\_ OF SURVEYS AT PAGE \_\_\_\_\_  
AT THE REQUEST OF WENGLER SURVEYING AND MAPPING CO.

\_\_\_\_\_  
DEPUTY COUNTY AUDITOR

AUDITOR'S FILE NUMBER \_\_\_\_\_

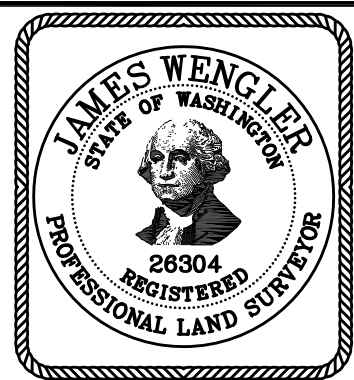

DATE: 8-11-2009

**SURVEYOR'S CERTIFICATE**

THIS MAP CORRECTLY REPRESENTS A SURVEY MADE BY ME OR UNDER MY DIRECTION IN CONFORMANCE WITH THE REQUIREMENTS OF THE SURVEY RECORDING ACT AT THE REQUEST OF THE PORT GAMBLE SKLALLAM TRIBE IN FEBRUARY, 2009.

JAMES WENGLER, P.L.S. 26304

**WENGLER SURVEYING & MAPPING CO.**

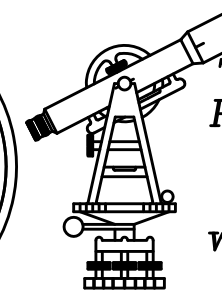
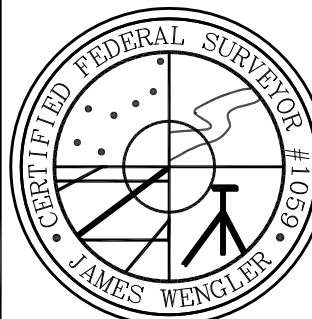

703 EAST EIGHTH STREET  
PORT ANGELES, WA. 98362  
(360)457-9600  
FAX (360)457-9556  
www.wenglersurveying.com